

RGB Animation Laser

→ User Manual

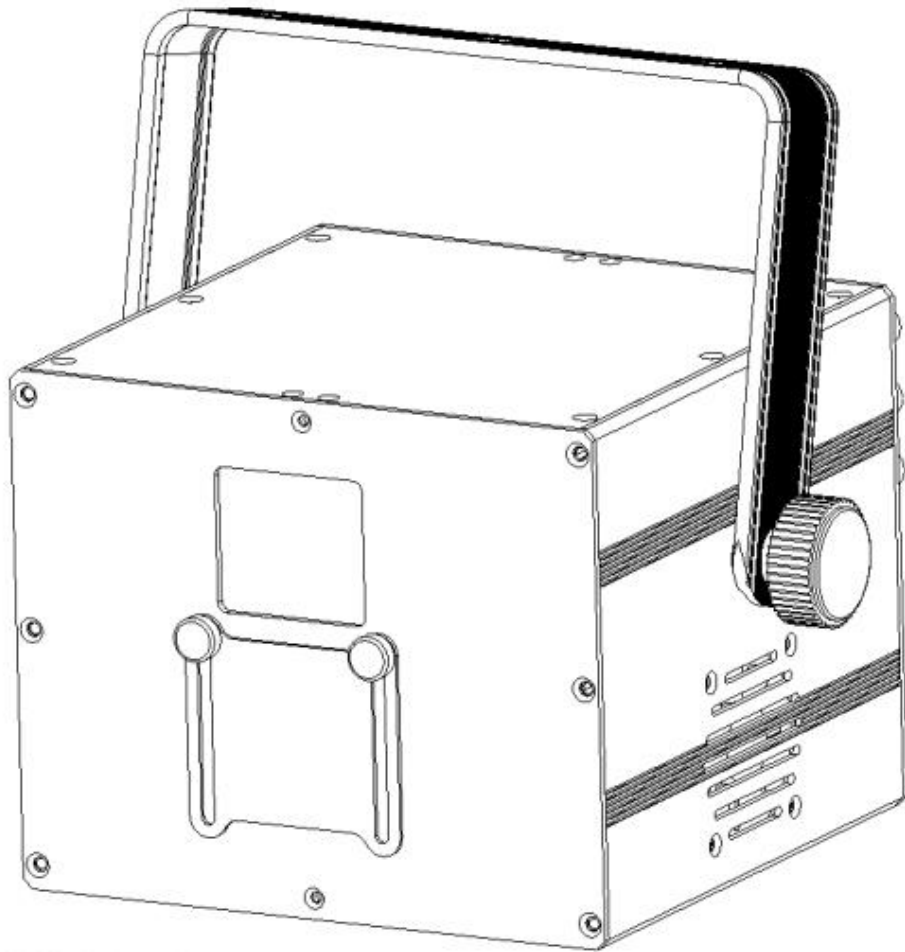

3W

Please read this manual carefully before use!

Contents

Introduction-----P2

Silkscreen on product-----P3

Safety instruction/Installation/Technical specification-----P4

SD control system/Menu-----P5

DMX512 Channel-----P6

DMX Address setting/DMX512 connection-----P7

Product size-----P8

Ringling-----P9

Cleaning and maintenance/Warning/Warranty card-----P10

Animation Laser User Manual

Introduction

Thank you for purchasing this product. To optimize the performance of this product, prior to use, please read these operating instructions carefully to familiarize yourself with the basic operation of this unit. Please keep the manual in safe place for future reference.

This unit has been tested at our factory before being shipped to you, there is no assembly required. Once after received this product, please take and put carefully. And check cautiously that whether the product was damaged or not during the transportation.

Checking Parts

Please check if the following parts are included:

1 x Laser light

1 x User manual

1 x Power cable

Caution

CAUTION!



Keep this device away from rain and moisture!



Unplug mains lead before opening the housing!



Warning!

Damages caused by the disregard of this user manual are not subject to warranty. The dealer will not accept liability for any resulting defects or

Symbol Instruction On The Device

 -----CE Certificate

 -----Only indoor use

 -----Environmental protection

 -----The minimum distance from lighted objects(meter)

$T_a = \text{---} \text{ } ^\circ \text{C}$ -----Max. Ambient Temp

$T_B = \text{---} \text{ } ^\circ \text{C}$ -----Max. Housing Temp

 ----- Safety caution

 -----Careful burns

 -----Careful electric shock



-----Not suitable for directly installed on the surface of ordinary combustible materials

Safety Instructions

- Please open and check whether break or not for transport once receive this fixture, if yes, not use it and contact dealer or manufacture as soon as possible.
- The Max applicable temperature for the light is 40°C. Do not use the light under or above the temperature. $t_a=40\text{ }^{\circ}\text{C}$
- The fixture is applicable for many occasions, it should keep clean, and avoid long use in overheating or dusty environment. To prevent the fixture from the chemical liquid .
- User must be careful of fire, heat, electric and fall-off that make heavy or fatal injury. Please read this user manual carefully before power on and installation, following safety and operation instruction in it. If still have any questions, please contact dealer or manufacture.
- User must following this user manual, do not open fixture by yourself, if any problems, please contact professional technician, maintenance should by technician.

Do not power on or start the fixture before installation, please stop after working more than 8 hours, which will longer use life.

- Fixed installation, do not by strong shocks.
- The minimum distance between light and the illuminated surface must be more than 1 meter. 
- Never look directly into the light source to avoid hurt to eyes (especially epileptics)!

When dustproof glass at light output breaks, cracks or other visible damage, user should replace with new glass to continue to use.

Installation

- When install this equipment please make sure there's no flammable surfaces (decorated things, etc) and minimum distance of 0.5M from the equipment to the flammable. 

- The installation of the effect has to be built and constructed in a way that it can hold 10 times the weight and without any harming deformation.
- The installation must always be secured with a secondary safety attachment, e.g. an appropriate safety rope. Never stand directly below the device when mounting, removing or servicing the fixture.

Technical Specifications

Input voltage: AC100-240V, 50/60Hz

Fuse: BGD Φ 5x20mm 250VAC F2A

Total power:75W

Light source: 3W RGB (600mW/638nm+600mW/520nm+1800mW/445nm)

Control mode: Auto/Sound/DMX512/ILDA/Master-slave/SD

Channels: 17CH

Scanning system: 30Kpps Scanner, $\pm 30^{\circ}$

Surface temp: $T_b=45^{\circ}\text{C}$ (this data testing when the environment temp is 30°C)

Working temp: 10°C -- 65°C

Modulation: Analog modulation

N.W: 4.1Kg

G.W: 5Kg

Carton packing size: 30*25*26cm

SD laser control system

1. MENU operation

Rotate the knob at display's right side to operate the menu, press knob to enter sub-menu or exit menu, after operation, double-click the knob to save the option and exit the menu.

The potentiometer at display's left side can adjust the power of laser: Red Current(adjust red laser power), Green Current(adjust green laser power),Blue Current (adjust blue laser power). Anti-clockwise rotation the potentiometer is down the power, and clockwise rotation is up the power. Below the display, safety key location, is closed the laser when the key at OFF, and is open when the key at ON.

2. MENU display

MENU	Display	Function
Dmx Address	1-512	DMX address setting
Show mode	Prg Mode	Display list mode: display PRG file, the 2rd line displays the current file name
	ILDA Mode	ILDA mode, display shows in ILDA file circularly (file's expanded-name is ILD)
	Sound	Sound activate mode
	Auto Mode	Auto mode
Sound sense	0-100	Sound sensitivity setting
SD File		choose SD card file
SIZE	0-100	Set pattern size
Phasic set		X Y
Speed set		Set show speed, set the speed according to the scanner speed, too high speed will hurt the scanner
DMX STATE	Show mode	When no DMX, the working mode is show mode
	Black out	When no DMX, light stands by
	HOLD	When no DMX, light holds the last scene
Slave	Master/ slave	Master/slave mode
Fixture Hours		Fixture total working hours
Version		Software version

Animation Laser User Manual

DMX Channel Instructions

Channel		Value	Function		
CH1	control mode	0-49	auto mode		
		50-99	sound activated mode		
		100-149	PRG file display orderly		
		150-199	ILD file display circularly		
		200-255	DMX Mode		
CH2	choose pattern/file	0-255	DMX Mode		
			PRG/ILD mode choose file		
CH3	strobe and display file	0-10	no strobe		
		11-199	strobe automatically from slow to fast		
		200-255	strobe via sound activated		
CH4	choose color	0-5	laser off		
		6-16	white	6-10	ILD file's original color
				11-16	white
		17-33	red		
		34-50	green		
		51-67	blue		
		68-84	yellow		
		85-101	purple		
		102-118	cyan		
		119-135	white, red, green, blue subsection		
		136-152	blue, yellow, purple, cyan subsection		
		153-169	white, red, green, blue, yellow, purple, cyan subsection		
		170-186	white, red, green, blue color flowing		
		187-203	blue, yellow, purple, cyan color flowing		
		204-220	white, red, green, blue, yellow, purple, cyan color flowing		
221-237	color subsection by pattern break-point				
238-255	color change by sound				
CH5	display	0-63	normal display		
		64-127	bright dot display		
		128-191	subsection display		
		192-255	dot display		
CH6	Horizontal Move	0-125	move with manual adjust		
		126-225	auto move from left to right circularly		
		226-245	auto jump randomly		
		246-255	random jump by sound control		
CH7	Vertical	0-125	move with manual adjust		
		126-225	auto move top-down circularly		
		226-245	auto jump randomly		
		246-255	random jump by sound control		
CH8	Zoom	0-10	no zoom		
		11-87	zoom by manual adjust		
		88-150	zoom out		
		151-200	zoom in		

Animation Laser User Manual

		201-255	zoom circularly
CH9	Horizontal rotation	0	no rotation
		1-128	manual adjust
		129-255	auto rotation
CH10	Vertical rotation	0	no rotation
		1-128	manual adjust
		129-255	auto rotation
CH11	center rotation	0	no rotation
		1-128	manual adjust
		129-192	auto rotation clockwise
		193-255	auto rotation anti-clockwise
CH12	gradual drawing	0-10	no drawing
		11-74	gradual drawing by manual adjust
		75-104	auto gradual drawing (increasing)
		105-144	auto gradual drawing (decreasing)
		145-184	auto gradual drawing circularly
		185-224	end to end gradual drawing circularly (increasing)
		225-255	end to end gradual drawing circularly (decreasing)
CH13	Horizontal wave	0-9	no wave
		10-69	small wave
		70-129	middle wave
		130-189	big wave
		190-255	biggest wave
CH14	Vertical wave	0-9	no wave
		10-69	small wave
		70-129	middle wave
		130-189	big wave
		190-255	biggest wave
CH15	red dimming	0-255	red dimming from 100%-0%
CH16	green dimming	0-255	green dimming from 100%-0%
CH17	blue dimming	0-255	blue dimming from 100%-0%

DMX-512 connection

DMX output



DMX Input



1: Ground
2: Signal (-)
3: Signal (+)

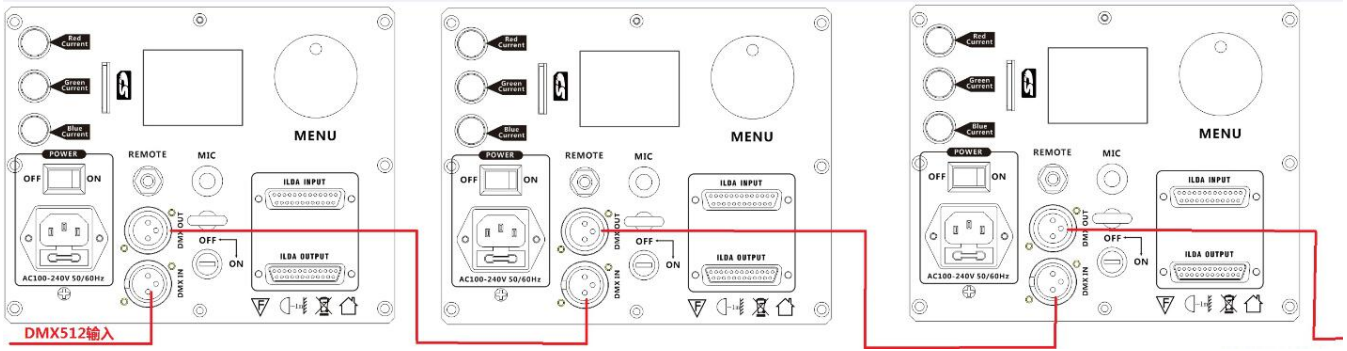

DMX In
First light (Address 001)

Second light (Address 018)

To the fourth
Third light(Address 035)

DMX Address setting

Each fixture must set a specific starting address. When receiving signal transmission, fixture will receive channel control signals which from the starting address.

According to different requirements or easy to use, the user can set many value fixtures to the same address, also can set up a separate address for every device.

If you set the same address,all the devices will receive from DMX channels signal. All connecting fixtures are jointly controlled, controller can't separate control a device.

If you set a different address, each device will be separate from its particular set the starting address and begin accepting DMX512 control signal, so that more convenient separate control one device. Using this method must be based on channel quantity of device to determine a starting address.

This laser light has 17 channels.you should set the starting address of the first unit to 1, the second unit to 18(1 + 17), the third unit to 35 (17*2+ 1), and so on.

Product Size

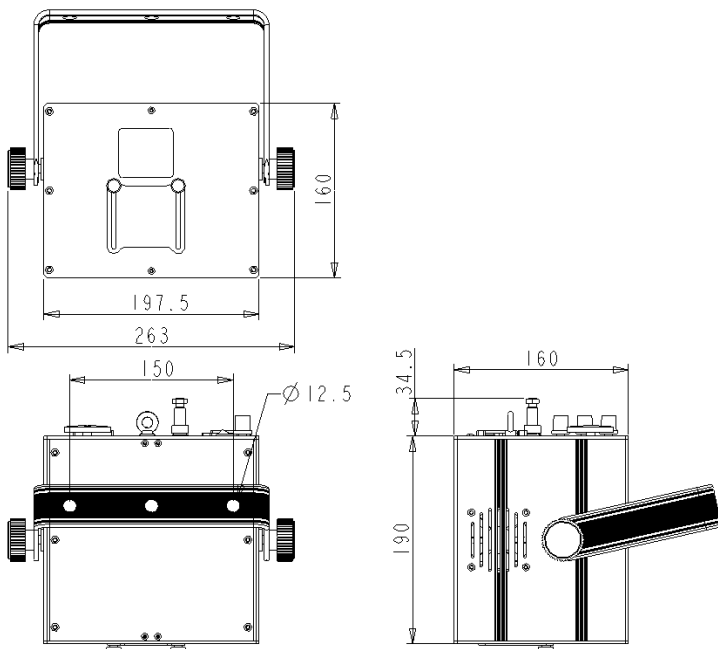

Ringing

1 Mounting bracket

2 Handle

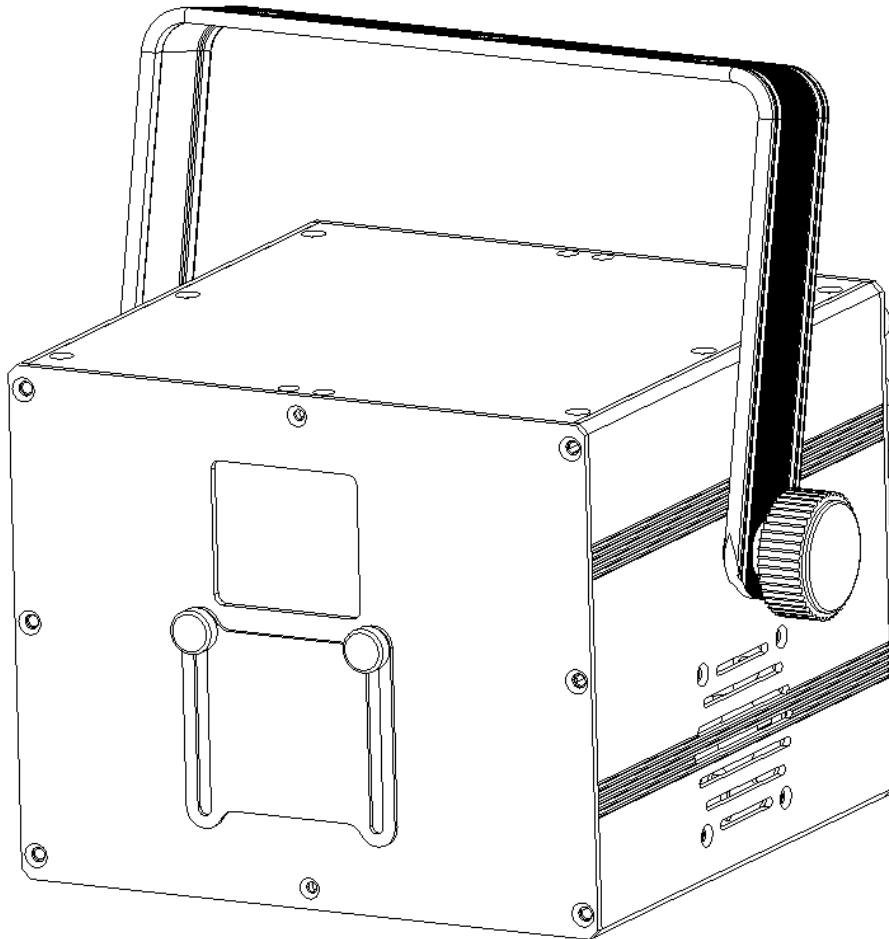
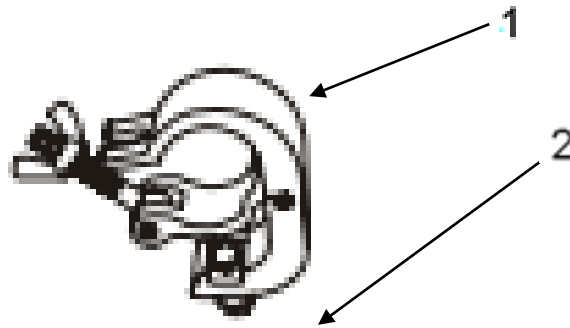

- A).The ambient temperature range is 1°C--45°C, must never be exceeded.
- B).The installation of the projector has to be built and constructed in a way that it can hold 10 times the weight for 1 hour without any harming deformation.
- C)).When rigging or servicing the fixture staying in the area below the installation place, on bridges,under high working places and other endangered areas is forbidden.
- D).The operator has to make sure that safety-relating and machine-technical installations are approved by an expert before taking into operation for the first time and after changes before taking into operation another time.
- E).The operator has to make sure that safety-relating and machine-technical installations are approved by a skilled person once a year.
- F). Sure M8 screws on mounting bracket fixed middle hole ϕ 12.5mm of handle

Cleaning and maintenance

Maintenance should be performed every 15-day period, by using a sponge which is dipped with alcohol, rather than wet cloth or other chemical liquid, to clean the mirror.

Always disconnect from the mains when the device is not in use or before cleaning it.

	Caution Make sure power off before cleaning and maintenance!
---	---

Warning

	Warning! Never look directly into the light source,as sensitive persons may suffer an epileptic shock(especially meant for epileptics)!
---	--

	Warning! Any power connected must by professional person
---	---

Warranty Card	
This product is made of high-brightness transistor. We will provide 1 year warranty under the condition that user has operated the light normally and lifetime service. We won't provide warranty if the damage is caused by artificial or force majeure event. Cost of fittings should be charged by user if product need maintenance after 1 year .Please cut this warranty card and shipped it along with the product to our factory when applying for warranty.	
Product:	
Purchasing date:	
Code of invoice:	
Warranty date: From	To
User's name:	Add:
Company:	Tel: